

# Linwood 56

**Length overall hull:** 56' 7"

**Beam:** 16' 6"

**Draft:** 3' 6"

**Displacement:** 48,000 lbs.

**Speed:** 30 Knots

**Fuel Capacity:** 800 U.S. gallons

**Fresh Water Capacity:** 200 U.S. gallons

## STRUCTURAL

**Hull, Deck and Superstructure** - Stitched E-glass with vinylester resin over closed cell foam

**Core** - Core Cell®

**Hull** - Huckins Quadraconic® planing design

## HULL, DECK AND SUPERSTRUCTURE

**Paint** - Two-part polyurethane Awlgrip®

**Windows** - Aluminum frames with tempered glass

**Hatches** - Low profile aluminum

**Toe Rail, Bow Pulpit, Accent Molding & Coverboard** - Varnished mahogany

**Rope Locker** - Huckins custom

**Bridge Windshield** - Electric opening with wipers

**Cleats** - Huckins custom chrome bronze

**Mast** - Aluminum

**Horn** - Dual trumpet electric

**Bow Rail** - Stainless steel

**Anchor Windlass & Gypsy** - 12V

**Transom Platform** - Teak

## BRIDGE

**Helm Station** - Engine gauges, controls, electronics, and mahogany spoke wheel

**Helm Seat** - Pedestal (centerline)

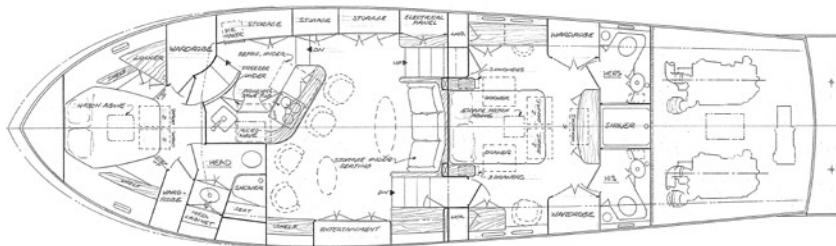

Two stateroom with salon/galley arrangement

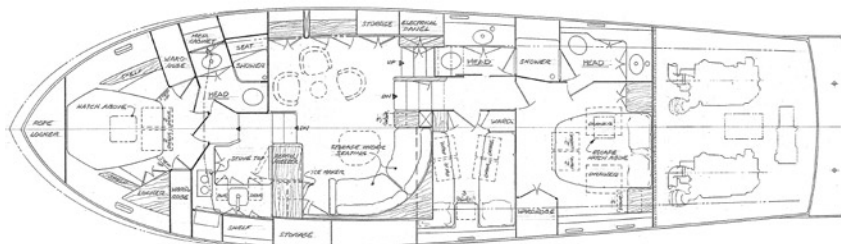

Three stateroom with step down galley arrangement

**Companion Seat** - Fiberglass base with storage, upholstered

**Lounge Seats** - Fiberglass base, storage under

**Bridge Enclosure** - Isinglass® roll up curtains

**Engine Access** - Electric lift hatch

## COCKPIT

**Locker** - Port & starboard

## INTERIOR

**Woodwork** - Selected cherry/mahogany woodwork and vinyl linen wallcovering; trim moldings and retainers, drawer fronts, cabinets & doors varnished

**Aft Stateroom** - Two wardrobes, king berth, drawers under berth

**Mid Ship Stateroom (Optional)** - Two twin berths, hanging locker, drawers under berth

**Forward Stateroom** - Two lockers, queen berth, drawers under berth

**Heads** - Corian® sink and vanity; toilet; fully enclosed shower

**Galley** - Refrigerator & freezer drawers, electric cooktop, microwave, stainless steel sink

**Salon** - Built-in lounge, entertainment cabinetry

## MECHANICAL

**Main Engines** - Selected from 660 hp diesels (2): Cummins®, Caterpillar®, Volvo®

**Main Gears** - Reduction

**Shafting** - Aquamet® 22 stainless steel shafts

**Struts, Propellers, Rudders** - Bronze

**Steering** - Hydraulic

**Air Conditioning** - Staterooms, salon, (bridgedeck - optional)

## PLUMBING

**Bilge** - Five each 12V bilge pumps with float switches

**Fresh Water System** - 12-volt DC water pressure pump; (2) 20-gallon hot water heaters

**Toilets** - Ceramic bowls flush to holding/treatment tank

## ELECTRICAL

**Wiring & Bonding** - All electrical installations conform to ABYC or USCG standards

**DC Power** - Engine start (2) 8D 12V DC; Ship service (2) 8D 12V DC; Generator (1) 12V

**AC Power** - 110V system supplied through 50-amp 230-volt shore receptacle

**Distribution Panel** - AC/DC controlled by master breaker panel

**Generator** - 20 KW diesel generator, optional 6 KW night generator

**Lighting** - 12V DC

# Linwood 56

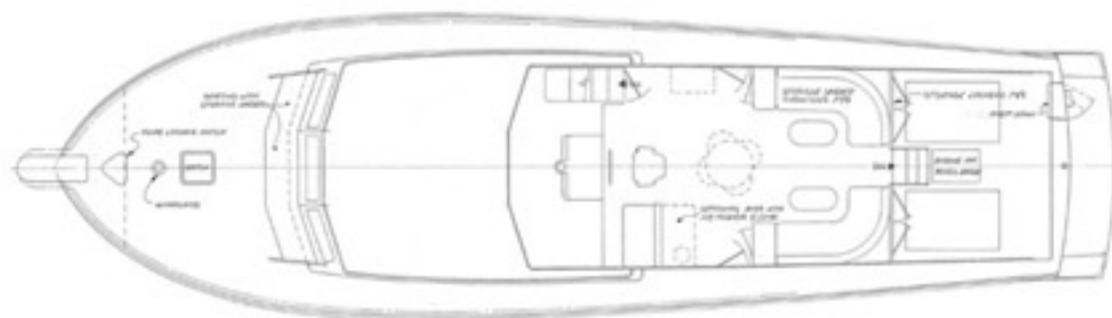
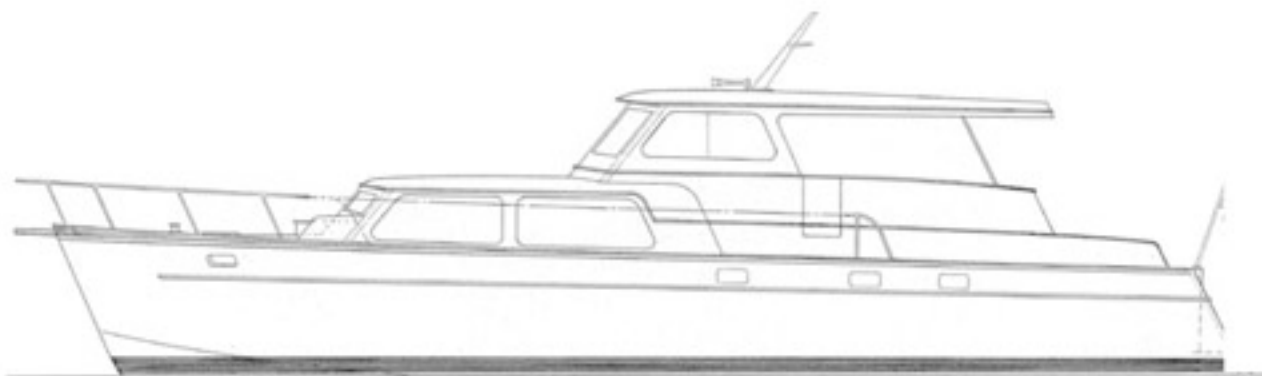

Two stateroom with  
salon/galley arrangement

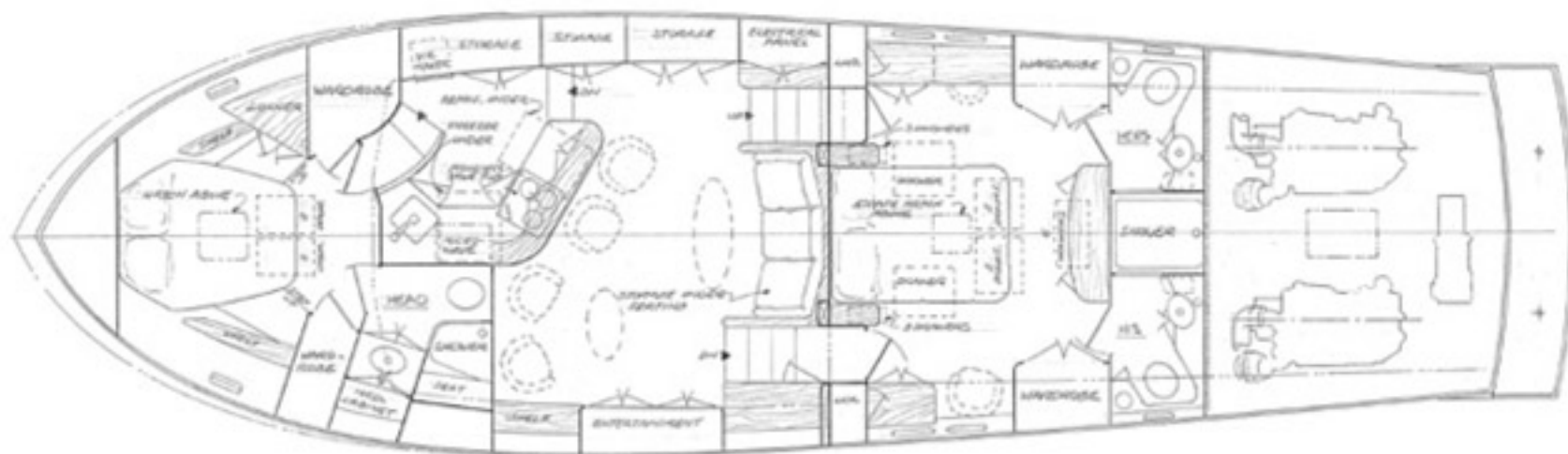

Three stateroom with  
step down galley arrangement

